

LID

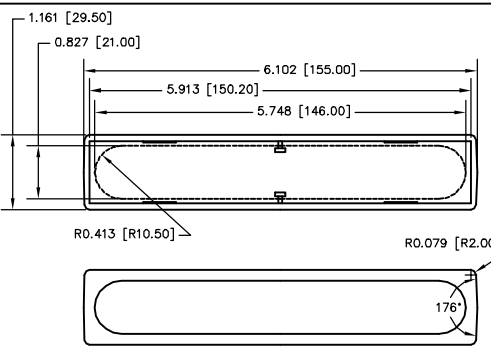

PANEL

TOLERANCES:		ITEM REQ'D	PART NO.	DESCRIPTION
±.005	BETWEEN HOLE CENTERS	MAT.	AS NOTED	SCALE:
±.005	FROM DIMENSIONED EDGE	FINISH	AS NOTED	NAME:
±.005	FROM A BENT SURFACE	DR. RD	10-13-08	BJID INDUSTRIES, INC.
±.005	BETWEEN ASSEMBLED SURFACES	CH.		WILLDOUGHBV, OHIO
	UNLESS OTHERWISE SPECIFIED	APP.		DWG NO. PC-11477
QTY.	USED ON			ISSUE REVISIONS

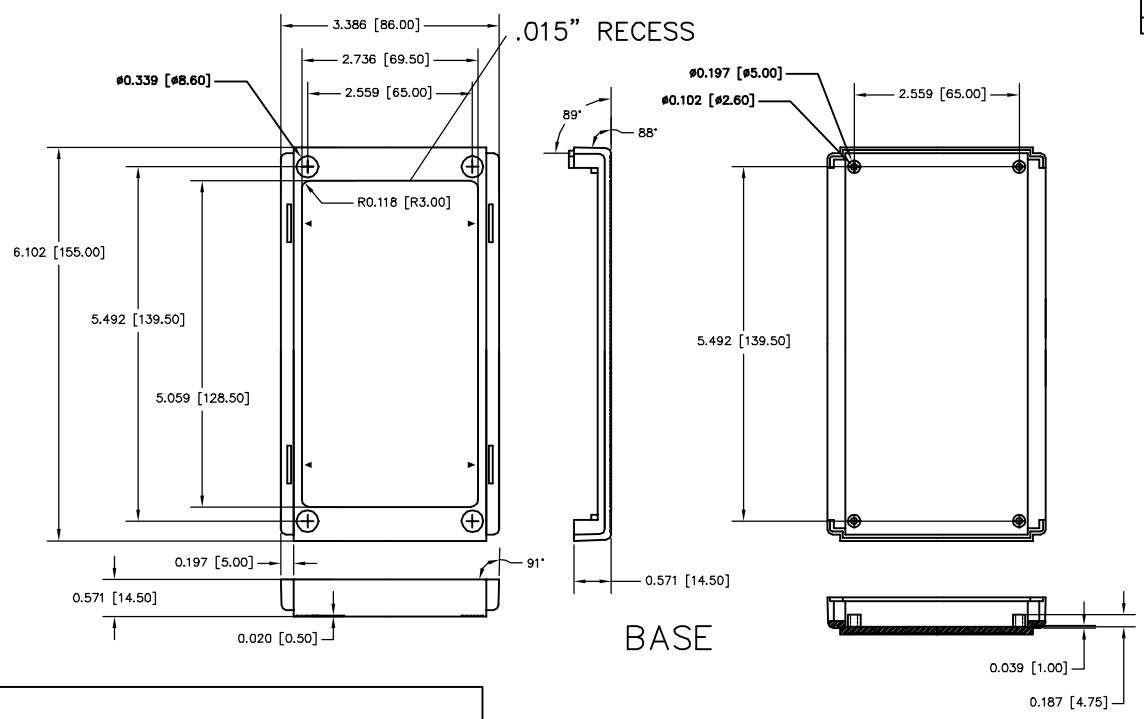

BASE

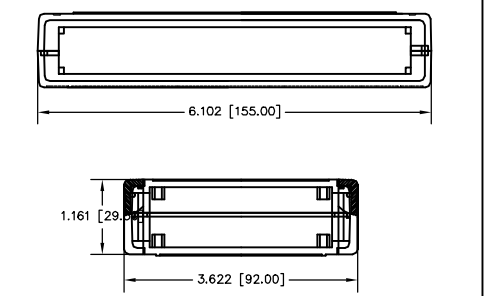

MATERIAL : HIGH IMPACT UL-94-HB ABS.
 COLOR:
 LID & BASE ARE MOLDED IN LIGHT GREY COLOR
 FRONT & END PANELS
 ARE MOLDED IN DARK GREY COLOR
 FINISH:
 FRONT & END PANELS ARE SMOOTH WITH TEXTURE ONLY IN THE RECESS AREA.
 LID & BASE ARE SMOOTH WITH TEXTURE ONLY IN OUTSIDE RAISED AREA.
 FOUR (4) INTERNAL BOSSES ON BASE & LID ARE
 AVAILABLE FOR PCB ASSEMBLY. USE M2.5 OR
 #4 STD SHEET METAL SCREWS.
 ALL DIMENSIONAL TOLERANCES ARE ±.015
 RUBBER FEET PART NUMBER ----- AVAILABLE AS ACCESSORY

TOLERANCES:		ITEM REQ'D	PART NO.	DESCRIPTION
±.005	BETWEEN HOLE CENTERS	MAT.	AS NOTED	SCALE:
±.005	FROM DIMENSIONED EDGE	FINISH	AS NOTED	NAME:
±.005	FROM A BENT SURFACE	DR. RD	10-13-08	BJID INDUSTRIES, INC.
±.005	BETWEEN ASSEMBLED SURFACES	CH.		WILLDOUGHBV, OHIO
	UNLESS OTHERWISE SPECIFIED	APP.		DWG NO. PC-11477
QTY.	USED ON			ISSUE REVISIONS