

- NOTES:  
 1. MATERIAL:PHOSPHOR BRONZE  
 2. FINISH: PER ES-88  
 102-TIN: .000200 MICROINCHES MIN OVER COPPER  
 501-GOLD: .000020 MICROINCHES MIN OVER NICKEL  
 THE PRIMARY SHIPPING CARTON WILL BE LABELED  
 \*COMPLIANT TO RoHS DIRECTIVE 2002/95/EC & ELV  
 ANNEX II OF DIRECTIVE 2003/53/EC\*. CARTONS W/O  
 THIS LABEL MAY CONTAIN PRODUCT WITH TIN-LEAD  
 IN THE PC TAIL AREA.  
 3. PRODUCT SPECIFICATION & PROCESSING PARAMETERS: NONE.  
 4. DIMENSIONS GIVEN ARE BEFORE PLATING.  
 5. SOLDERABILITY SPECIFICATION: SMES-152 AFTER PLATING.  
 6. CAMBER SPECIFICATION: .003 MM/MM OR .003 IN/IN.  
 7. BURR SPECIFICATION ES-151.  
 8. RECOMMENDED PCB HOLE SPECIFICATION FOR PRESS FIT PINS:  
 .062 THK. PCB  
 PUNCHED HOLES: .030±.002/.762±0.05  
 DRILLED HOLES: .031±.0015/.0787±0.038  
 PLATED THRU HOLES: .0295±.0025/.749±0.064

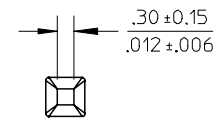
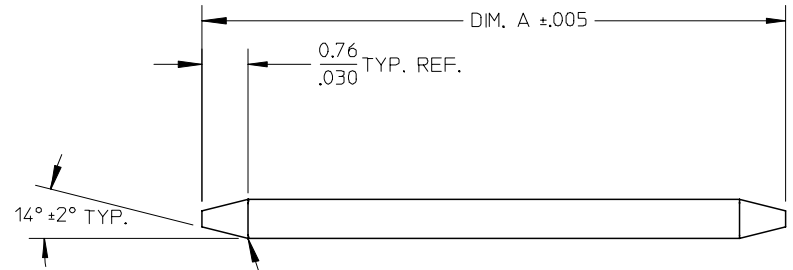

PART TO BE FREE OF ALL TOOL MARKS DUE TO COINING & TRIMMING OPERATION.

33	26.21 1.032		
31	31.75 1.250	74	31.24 1.230
30	30.48 1.200	69	20.85 .821
27	21.39 .842	68	18.29 .720
25	9.65 .380	67	16.94 .667
22	15.88 .625	66	15.49 .610
20	20.32 .800	65	14.61 .575
18	11.71 .461	64	13.08 .515
17	11.99 .472	60	10.01 .394
15	12.70 .500	58	8.56 .337
12	22.23 .875	47	19.69 .775
11	16.51 .650	46	17.86 .703
10	28.58 1.125	43	38.10 1.500
9	18.69 .736	42	13.84 .545
8	25.40 1.000	41	29.21 1.150
7	14.99 .590	40	34.93 1.375
5	11.10 .437	39	24.38 .960
4	13.46 .530	38	27.00 1.063
3	17.45 .687	37	19.05 .750
2	10.29 .405	35	23.80 .937
1	14.22 .560	34	32.26 1.270
N	DIM. A	N	DIM. A

EC NO: UCP2004-1675  
 DRWN: JSCHAFFER2004/03/08  
 CHK'D: 2004/03/11  
 APPR: YMARGULI 2004/03/17

QUALITY SYMBOLS	GENERAL TOLERANCES (UNLESS SPECIFIED)		SCALE 8:1	DESIGN UNITS INCH	THIRD ANGLE PROJECTION	REVISE ON CAD ONLY
	mm	INCH	DIMENSION STYLE MM/IN		TITLE TERMINAL PIN 0.647.025 SQ. WIRE	
	4 PLACES ± ---	± ---	DRAWN BY SCHAFFER	DATE 2004/03/01	MOLEX INCORPORATED	
	3 PLACES ± ---	± ---	CHECKED BY SAMIEC	DATE 2004/03/04		
2 PLACES ± ---	± ---	APPROVED BY MARGULIS		MATERIAL NO. SEE CHART	DOCUMENT NO. SD-4166-001	SHEET NO. 1 OF *
1 PLACE ± ---	± ---	ANGULAR ±1/2°		THIS DRAWING CONTAINS INFORMATION THAT IS PROPRIETARY TO MOLEX INCORPORATED AND SHOULD NOT BE USED WITHOUT WRITTEN PERMISSION		
DRAFT WHERE APPLICABLE MUST REMAIN WITHIN DIMENSIONS						

GEN.DOCS.	SHEETS 2-*	AJ
ANNOTATOR	SHEET 1	AJ
DOC. TYPE	SHEETS	REV.







PART NO:	ENG NO:	PART NO:	ENG NO:
08-52-0711	4166-1(224)		4166-33(224)
	4166-2(224)		
	4166-3(224)		4166-35(224)
	4166-4(224)		4166-38(224)
	4166-5(224)		4166-39(224)
	4166-7(224)		4166-41(224)
	4166-8(224)		4166-42(224)
	4166-9(224)		4166-43(224)
	4166-10(224)		4166-46(224)
	4166-11(224)		4166-47(224)
	4166-12(224)		4166-58(224)
	4166-15(224)		4166-60(224)
			4166-64(224)
	4166-18(224)		4166-65(224)
	4166-20(224)		4166-66(224)
	4166-22(224)		4166-67(224)
	4166-25(224)		4166-68(224)
08-52-0727	4166-27(224)		4166-69(224)
	4166-30(224)		4166-74(224)
	4166-31(224)		

PART NO:	ENG NO:	PART NO:	ENG NO:
08-58-0611	4166-1(501)	08-58-0633	4166-33(501)
	4166-2(501)	08-58-0634	4166-34(501)
08-58-0613	4166-3(501)	08-58-0635	4166-35(501)
	4166-4(501)		4166-38(501)
	4166-5(501)		4166-39(501)
	4166-7(501)	08-58-0641	4166-41(501)
08-58-0668	4166-8(501)		4166-42(501)
	4166-9(501)	08-58-0643	4166-43(501)
	4166-10(501)		4166-46(501)
	4166-11(501)		4166-47(501)
08-58-0612	4166-12(501)		4166-58(501)
	4166-15(501)		4166-60(501)
08-58-0614	4166-17(501)		4166-64(501)
08-58-0608	4166-18(501)		4166-65(501)
08-58-0646	4166-20(501)		4166-66(501)
08-58-0688	4166-22(501)		4166-67(501)
	4166-25(501)		4166-68(501)
	4166-27(501)		4166-69(501)
08-58-0630	4166-30(501)	08-58-0674	4166-74(501)
08-58-0631	4166-31(501)		

REV: <b>AJ</b>	SEE SHEET 1	TITLE: <b>KK .025 SQ PIN</b>	SHEET No. <b>- 5 -</b>
DOCUMENT NUMBER: <b>SD- 4166-001</b>	CREATED / REVISED BY: <b>SCHAFFER</b>	CHECKED BY: <b>SAMIEC</b>	APPROVED BY: <b>MARGULIS</b>





